

# MONOLINE CORE BIKE RACK + BOLLARD

Simple, purposeful, and functional, the Core Bike Rack blends in with its surroundings. Use it for its intended purpose as a bike rack but know that it's also well suited as a pedestrian bollard.

- all aluminum frame construction
- powder coated finish
- surface mount + in-ground mount options
- countersunk holes for surface mounting
- two-bike capacity
- not rated as a vehicular bollard

product:	length:	width:	height:
ML-CORE8	8"	3"	36"
ML-CORE8-IG	8"	3"	36"

NOTE: "-IG" at the end of the product number represents the in-ground mount option

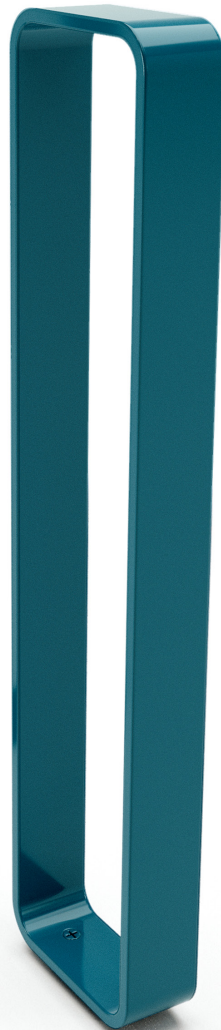

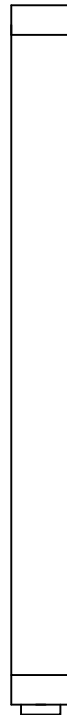
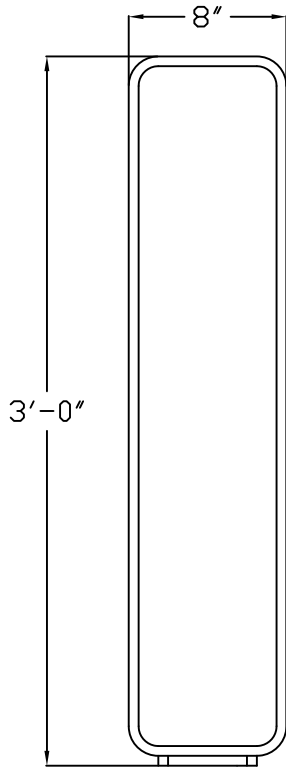

**NOTES:**

- ALL ALUMINUM CONSTRUCTION
- 1/2" PRE-DRILLED COUNTERSUNK HOLES FOR SURFACE MOUNTING
- SITE PIECES RECOMMENDS STAINLESS STEEL FLAT HEAD DROP-IN ANCHORS
- SHIPS FULLY ASSEMBLED

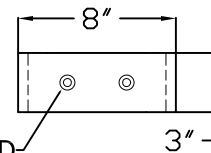

PRE-DRILLED  
COUNTERSUNK HOLES

GENERAL NOTES: NOT DRAWN TO SCALE \*- CRITICAL DIMENSIONS

ALL DIMENSIONS ARE NOMINAL. ANY AND ALL INFORMATION ON THIS DRAWING IS PROPRIETARY AND BELONGS TO SITE PIECES, LLC. THIS DRAWING MAY NOT BE ALTERED WITHOUT PERMISSION FROM SITE PIECES, LLC. 3000 LAWRENCE ST. #57 DENVER, CO 80205

**PRODUCT: ML-CORE8**  
**DESCRIPTION: MONOLINE CORE BIKE RACK | SURFACE MOUNT**

**FINISHES: SEE PRODUCT MATERIAL SHEETS**  
**SCALE: NTS**

*site pieces*

SITE PIECES  
 3000 LAWRENCE STREET #57  
 DENVER, CO 80205

800.484.0797  
[www.sitepieces.com](http://www.sitepieces.com)  
[hello@sitepieces.com](mailto:hello@sitepieces.com)

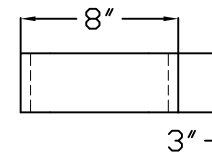
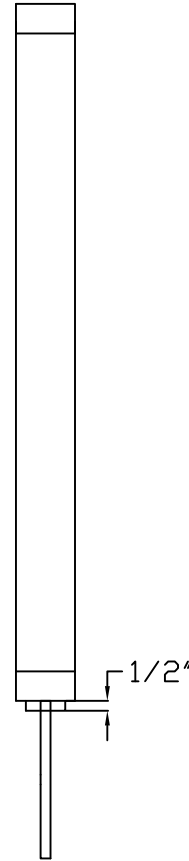
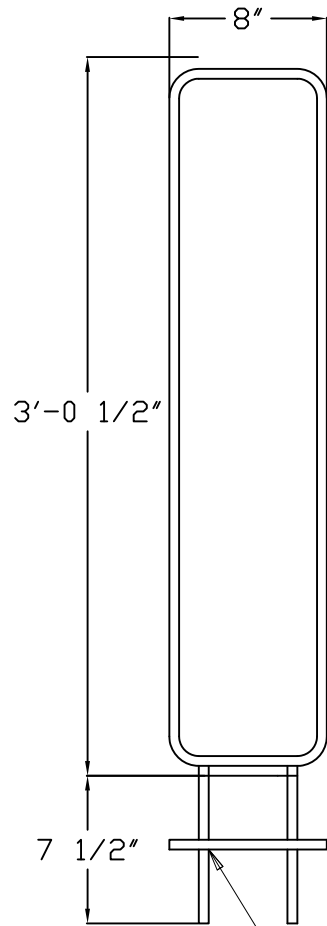

NOTES:

- ALL ALUMINUM CONSTRUCTION
- MOUNTING TYPE - INGROUND
- SHIPS FULLY ASSEMBLED
- POWDER COAT COLOR: TBD

INGROUND MOUNT SYSTEM

GENERAL NOTES: NOT DRAWN TO SCALE - CRITICAL DIMENSIONS

ALL DIMENSIONS ARE NOMINAL. ANY AND ALL INFORMATION ON THIS DRAWING IS PROPRIETARY AND BELONGS TO SITE PIECES, LLC. THIS DRAWING MAY NOT BE ALTERED WITHOUT PERMISSION FROM SITE PIECES, LLC. 3000 LAWRENCE ST. #57 DENVER, CO 80205

PRODUCT: ML-CORE8-IG  
 DESCRIPTION: MONOLINE CORE BIKE RACK | INGROUND MOUNT

FINISHES: SEE PRODUCT MATERIAL SHEETS  
 SCALE: NTS

*site pieces*

SITE PIECES  
 3000 LAWRENCE STREET #57  
 DENVER, CO 80205

800.484.0797  
 www.sitepieces.com  
 hello@sitepieces.com