

Monoline Solid Series 20X20 Planters



The Monoline Solid Series Planters pair perfectly with Monoline Stools so you can mix them together to bring planting into your space. Let them stand alone, use them in clusters, or use the two different heights to create a layered look.

- all aluminum frame construction
- self-irrigation systems are available
- pre-drilled drainage and irrigation holes provided
- powder coated finish
- freestanding or surface mount options
- contact us with special requests
- ships fully assembled

PRODUCT:	LENGTH:	WIDTH:	HEIGHT:
ML-SSPL-SQ2016	20"	20"	14.5"
ML-SSPL-SQ2030	20"	20"	28.5"



Monoline Solid Series 40X40 Planters



The Monoline Solid Series Planters pair perfectly with Monoline Stools so you can mix them together to bring planting into your space. Let them stand alone, use them in clusters, or use the two different heights to create a layered look.

- all aluminum frame construction
- self-irrigation systems are available
- pre-drilled drainage and irrigation holes provided
- powder coated finish
- freestanding or surface mount options
- contact us with special requests
- ships fully assembled

PRODUCT:	LENGTH:	WIDTH:	HEIGHT:
ML-SSPL-SQ4016	40"	40"	14.5"
ML-SSPL-SQ4030	40"	40"	28.5"



Monoline Solid Series 40X20 Planters



The Monoline Solid Series Planters pair perfectly with Monoline Stools so you can mix them together to bring planting into your space. Let them stand alone, use them in clusters, or use the two different heights to create a layered look.

- all aluminum frame construction
- self-irrigation systems are available
- pre-drilled drainage and irrigation holes provided
- powder coated finish
- freestanding or surface mount options
- contact us with special requests
- ships fully assembled

PRODUCT:	LENGTH:	WIDTH:	HEIGHT:
ML-SSPL-RECT4016	40"	20"	14.5"
ML-SSPL-RECT4030	40"	20"	28.5"



PRODUCT SPECIFICATIONS

ALL ALUMINUM FRAME CONSTRUCTION

POWDER COAT COLOR: _____

MOUNTING TYPE:

- FREESTANDING
- SURFACE MOUNTED

PRODUCT SHIPS FULLY ASSEMBLED

MOUNTING HARDWARE NOT INCLUDED

SEE INSTALLATION SHEET FOR ADDITIONAL INFORMATION

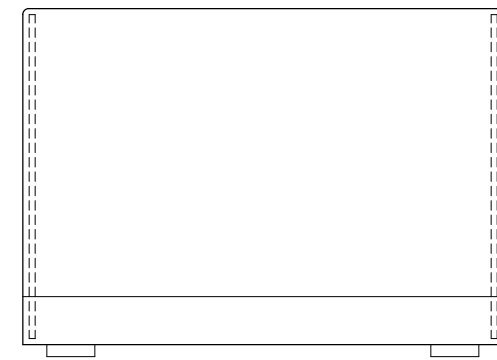
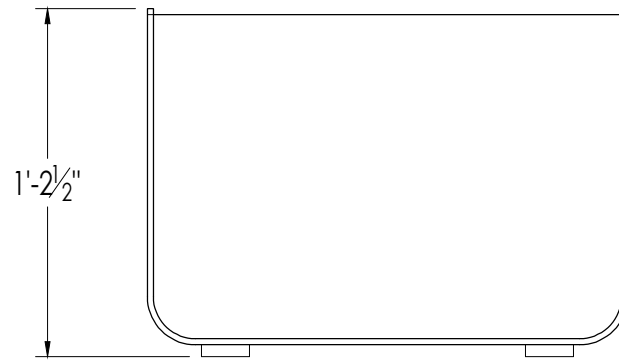
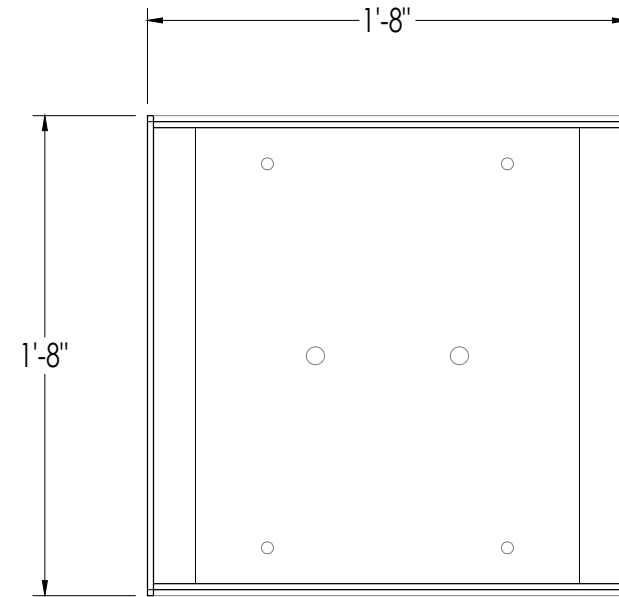

site pieces

ALL DIMENSIONS ARE NOMINAL
ANY AND ALL INFORMATION ON THIS DRAWING
MAY BE PROPRIETARY TO SITE PIECES, LLC
AND MAY NOT BE COPIED OR ALTERED WITHOUT
PERMISSION FROM SITE PIECES, LLC.
3575 RINGSBY COURT #418 DENVER, CO 80216

PRODUCT: MONOLINE SOLID SERIES PLANTER
PRODUCT #: ML-SSPL-SQ2016

SIZE: 20" X 20" X 14.5"
APPROXIMATE WEIGHT: 25 LBS
SCALE: 1-1/2"=1'0"

CREATION DATE: 2022-02-24
UPDATED: 3/15/2024

SHEET: 1/1

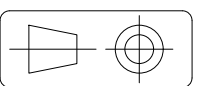

PRODUCT SPECIFICATIONS

ALL ALUMINUM FRAME CONSTRUCTION

POWDER COAT COLOR: _____

MOUNTING TYPE:

FREESTANDING

SURFACE MOUNTED

PRODUCT SHIPS FULLY ASSEMBLED

MOUNTING HARDWARE NOT INCLUDED

SEE INSTALLATION SHEET FOR ADDITIONAL INFORMATION

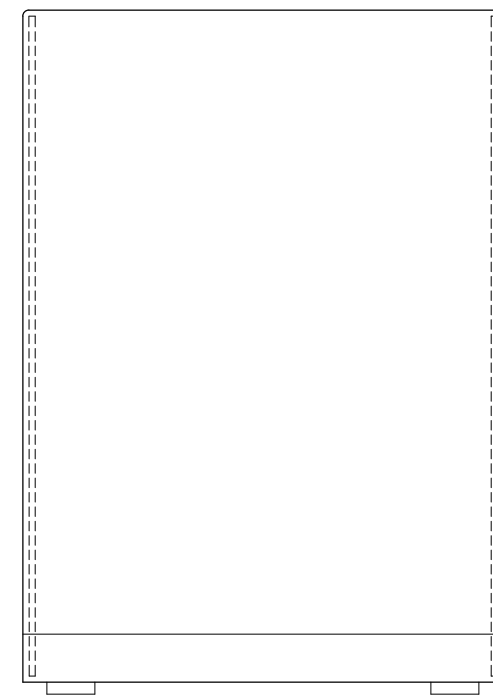
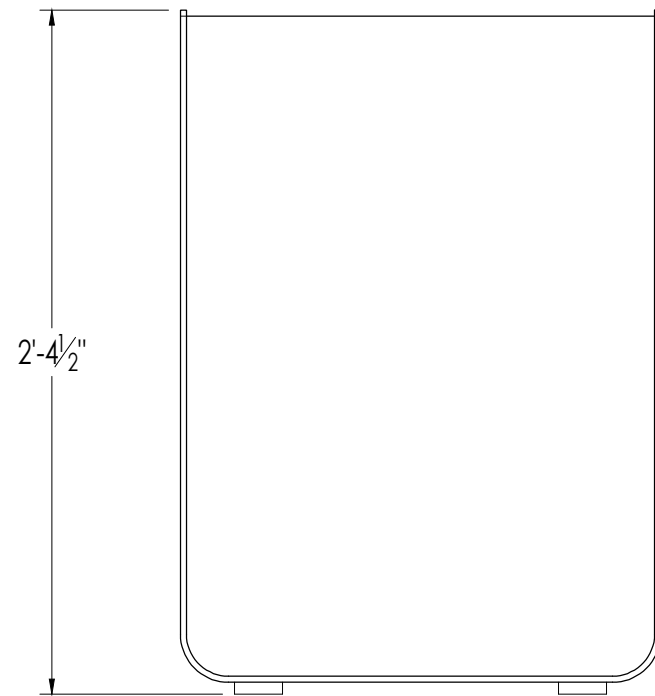
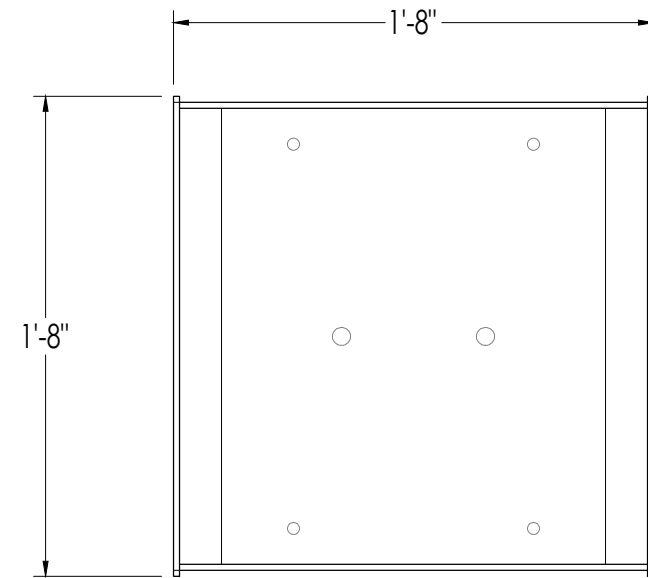

site pieces

ALL DIMENSIONS ARE NOMINAL
ANY AND ALL INFORMATION ON THIS DRAWING
MAY BE PROPRIETARY TO SITE PIECES, LLC
AND MAY NOT BE COPIED OR ALTERED WITHOUT
PERMISSION FROM SITE PIECES, LLC.
3575 RINGSBY COURT #418 DENVER, CO 80214

PRODUCT: MONOLINE SOLID SERIES PLANTER
PRODUCT #: ML-SSPL-SQ2030

SIZE: 20" X 20" X 28.5"
APPROXIMATE WEIGHT: 35 LBS
SCALE: 1-1/2"=1'0"

CREATION DATE: 2022-02-24
UPDATED: 3/15/2024

SHEET: 1/1

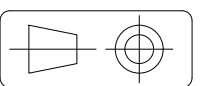

PRODUCT SPECIFICATIONS

ALL ALUMINUM FRAME CONSTRUCTION

POWDER COAT COLOR: _____

MOUNTING TYPE:

- FREESTANDING
- SURFACE MOUNTED

PRODUCT SHIPS FULLY ASSEMBLED

MOUNTING HARDWARE NOT INCLUDED

SEE INSTALLATION SHEET FOR ADDITIONAL INFORMATION

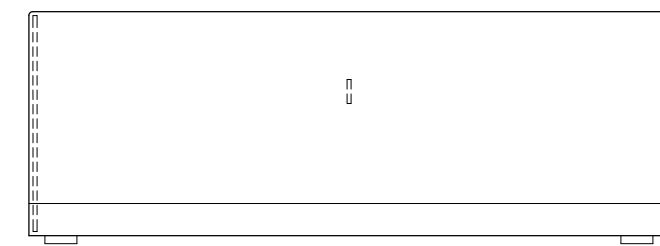
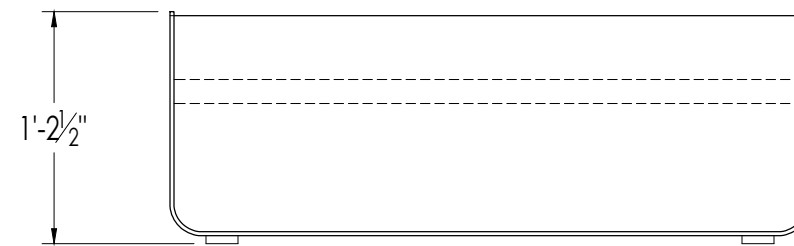
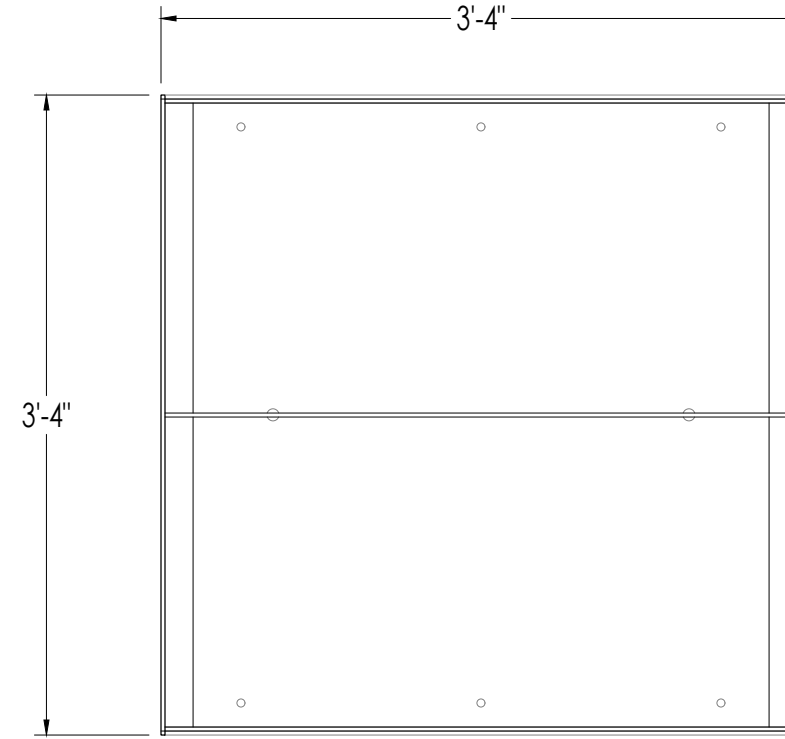

site pieces

ALL DIMENSIONS ARE NOMINAL
ANY AND ALL INFORMATION ON THIS DRAWING
MAY BE PROPRIETARY TO SITE PIECES, LLC
AND MAY NOT BE COPIED OR ALTERED WITHOUT
PERMISSION FROM SITE PIECES, LLC.
3575 RINGSBY COURT #418 DENVER, CO 80216

PRODUCT: MONOLINE SOLID SERIES PLANTER
PRODUCT #: ML-SSPL-SQ4016

SIZE: 40" X 40" X 14.5"
APPROXIMATE WEIGHT: 65 LBS
SCALE: 1"=1'0"

CREATION DATE: 2022-02-24
UPDATED: 3/15/2024

SHEET: 1/1

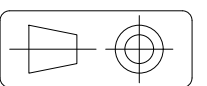

PRODUCT SPECIFICATIONS

ALL ALUMINUM FRAME CONSTRUCTION

POWDER COAT COLOR: _____

MOUNTING TYPE:

- FREESTANDING
- SURFACE MOUNTED

PRODUCT SHIPS FULLY ASSEMBLED

MOUNTING HARDWARE NOT INCLUDED

SEE INSTALLATION SHEET FOR ADDITIONAL INFORMATION

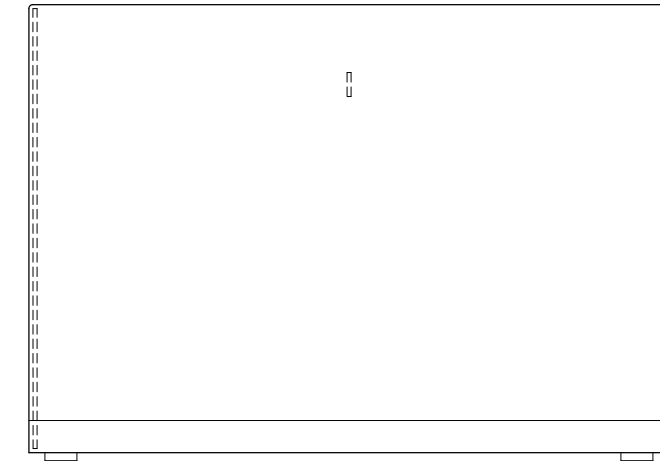
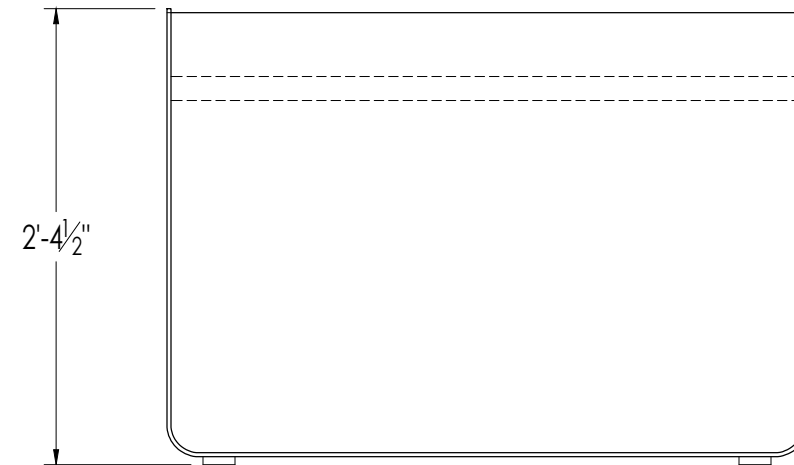
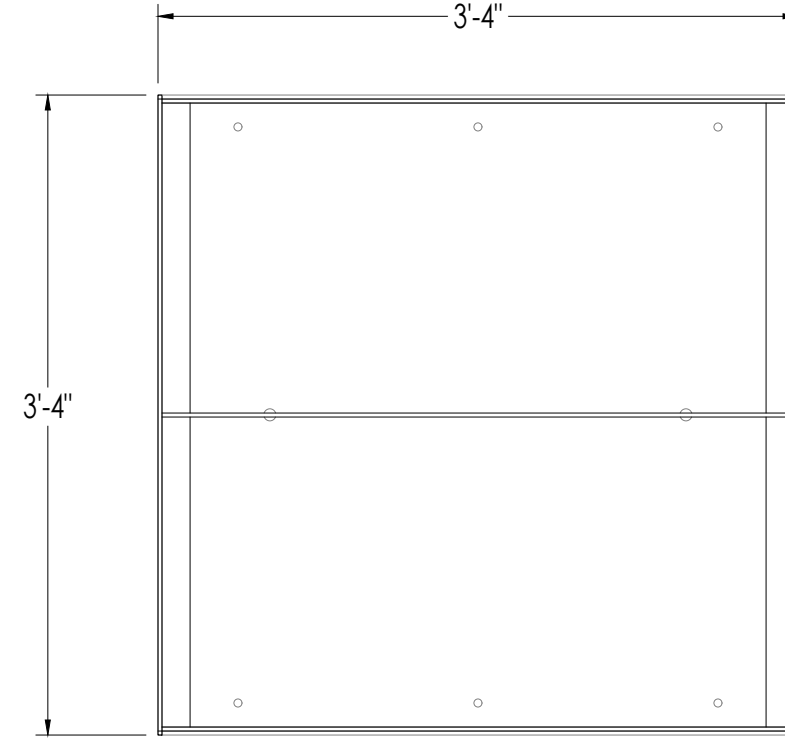

site pieces

ALL DIMENSIONS ARE NOMINAL
ANY AND ALL INFORMATION ON THIS DRAWING
MAY BE PROPRIETARY TO SITE PIECES, LLC
AND MAY NOT BE COPIED OR ALTERED WITHOUT
PERMISSION FROM SITE PIECES, LLC.
3575 RINGSBY COURT #418 DENVER, CO 80214

PRODUCT: MONOLINE SOLID SERIES PLANTER
PRODUCT #: ML-SSPL-SQ4030

SIZE: 40" X 40" X 28.5"
APPROXIMATE WEIGHT: 75 LBS
SCALE: 1"=1'0"

CREATION DATE: 2022-02-24
UPDATED: 3/15/2024

SHEET: 1/1

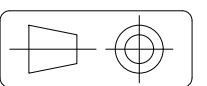

PRODUCT SPECIFICATIONS

ALL ALUMINUM FRAME CONSTRUCTION

POWDER COAT COLOR: _____

MOUNTING TYPE:

FREESTANDING

SURFACE MOUNTED

PRODUCT SHIPS FULLY ASSEMBLED

MOUNTING HARDWARE NOT INCLUDED

SEE INSTALLATION SHEET FOR ADDITIONAL INFORMATION

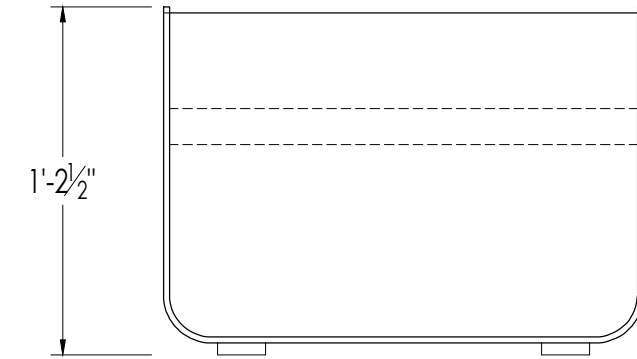
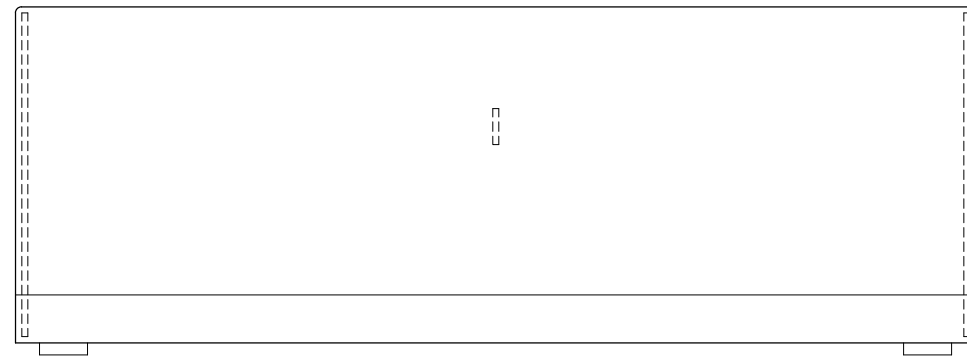
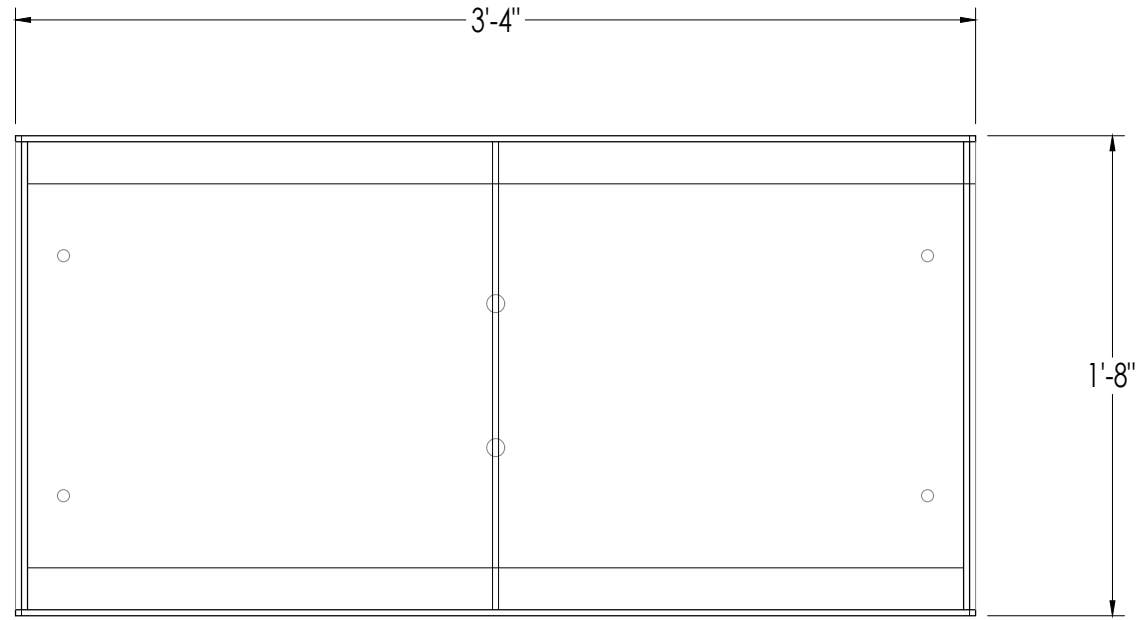

site pieces

ALL DIMENSIONS ARE NOMINAL
ANY AND ALL INFORMATION ON THIS DRAWING
MAY BE PROPRIETARY TO SITE PIECES, LLC
AND MAY NOT BE COPIED OR ALTERED WITHOUT
PERMISSION FROM SITE PIECES, LLC.
3575 RINGSBY COURT #418 DENVER, CO 80216

PRODUCT: MONOLINE SOLID SERIES PLANTER
PRODUCT #: ML-SSPL-RECT4016

SIZE: 40" X 20" X 14.5"
APPROXIMATE WEIGHT: 45 LBS
SCALE: 1-1/2"=1'0"

CREATION DATE: 2022-02-24
UPDATED: 3/15/2024

SHEET: 1/1

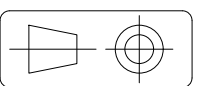

PRODUCT SPECIFICATIONS

ALL ALUMINUM FRAME CONSTRUCTION

POWDER COAT COLOR: _____

MOUNTING TYPE:

- FREESTANDING
- SURFACE MOUNTED

PRODUCT SHIPS FULLY ASSEMBLED

MOUNTING HARDWARE NOT INCLUDED

SEE INSTALLATION SHEET FOR ADDITIONAL INFORMATION

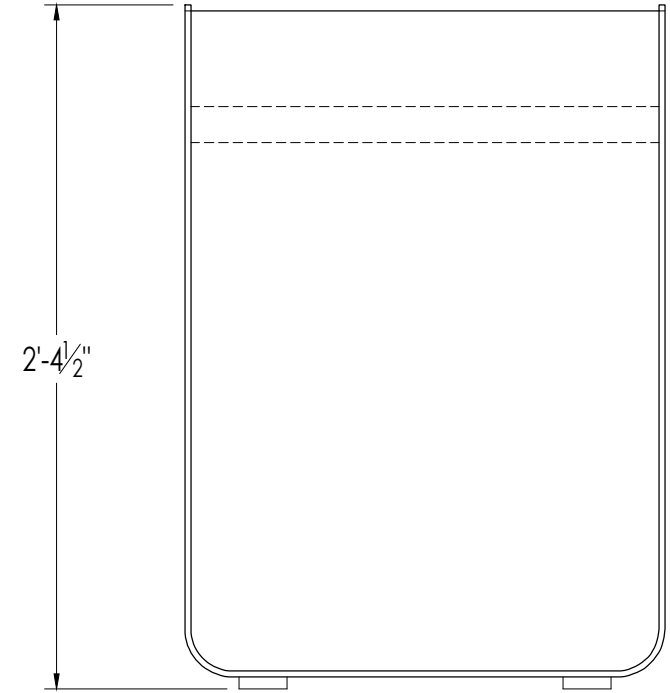
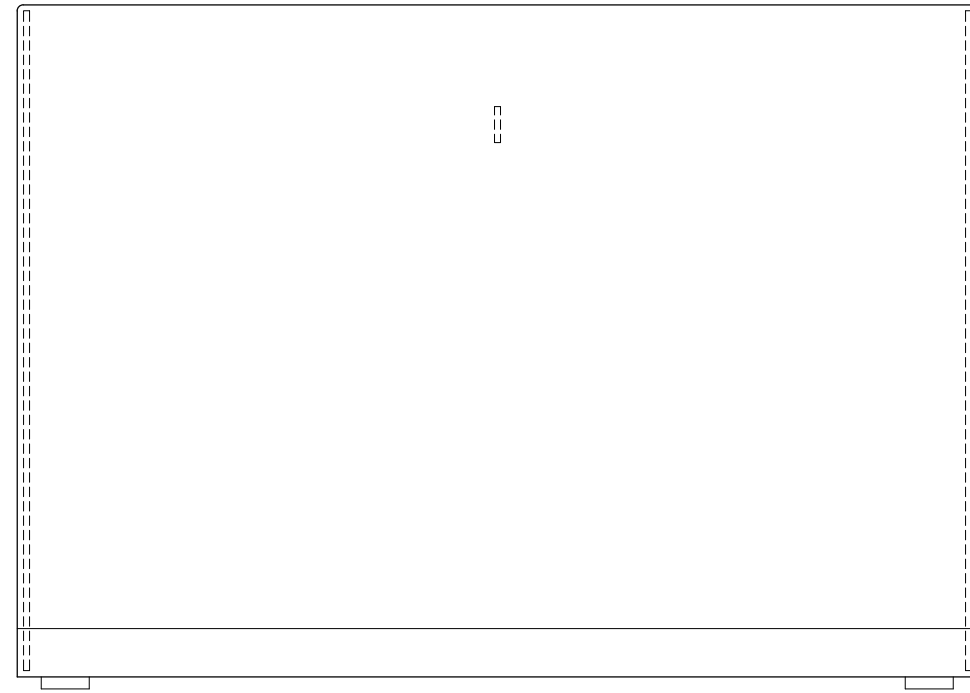
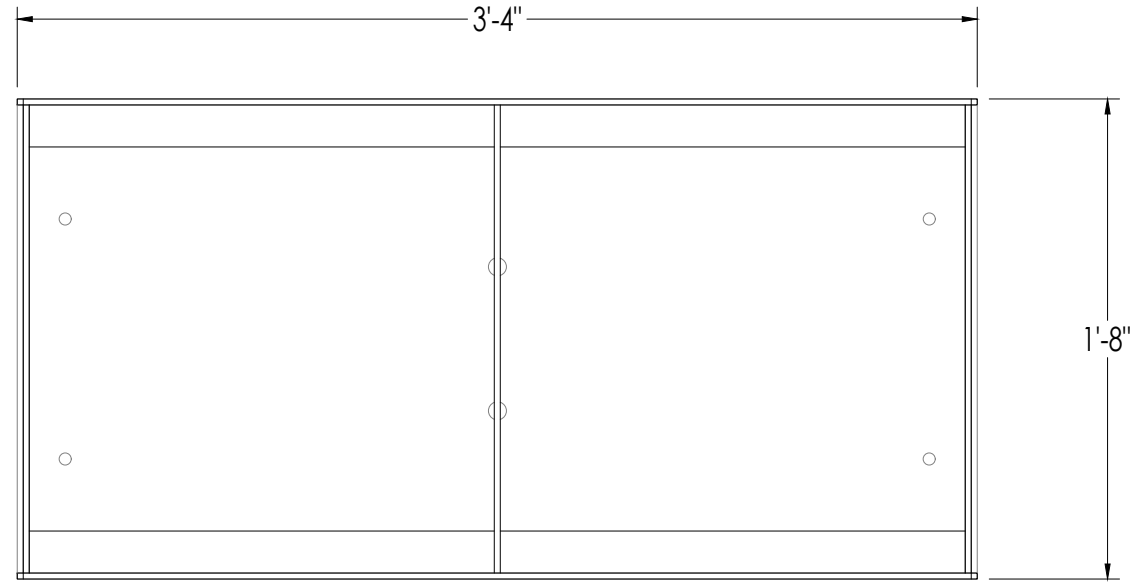

site pieces

ALL DIMENSIONS ARE NOMINAL
ANY AND ALL INFORMATION ON THIS DRAWING
MAY BE PROPRIETARY TO SITE PIECES, LLC
AND MAY NOT BE COPIED OR ALTERED WITHOUT
PERMISSION FROM SITE PIECES, LLC.
3575 RINGSBY COURT #418 DENVER, CO 80214

PRODUCT: MONOLINE SOLID SERIES PLANTER
PRODUCT #: ML-SSPL-RECT4030

SIZE: 40" X 20" X 28.5"
APPROXIMATE WEIGHT: 55 LBS
SCALE: 1-1/2"=1'0"

CREATION DATE: 2022-02-24
UPDATED: 3/15/2024

SHEET: 1/1

